



COMPANY PROFILE

2025

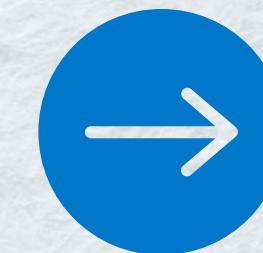

TABLE OF CONTENTS

Foreword

Vision & Mission

Core Values

Our Services

Our Strategic Partners

Our Key Projects

Contact

FOREWORD

We are honored to introduce the **Company Profile of USDC Technology**.

Since our founding, USDC has been committed to delivering end-to-end, high-performance data center solutions in Vietnam — from consultancy and design to construction, operation, and audit. Our mission is clear: to maximize client value through integrated, professional services.

We prioritize people, collaboration, and excellence — building trust through experience, expertise, and results.

We look forward to the opportunity to work with you and become a trusted partner on your path to innovation and operational excellence.

Yours Faithfully,

Mr. Hai Nguyen
CEO of Universal Smart Data Center Technology JSC.



ABOUT THE COMPANY

USDC Technology stands as the vanguard in the data center industry, boasting a decade of unparalleled expertise. As a trailblazer of innovative trends and technologies, we're reshaping the landscape of smart data centers in Vietnam and beyond. Backed by a remarkable team with over 10 years of experience, we're dedicated to nurturing enduring relationships with our valued clients. Through strategic collaborations with premier technology partners, we equip our customers with seamless, secure, and cost-effective solutions, ensuring uninterrupted operations.

Embark on this exhilarating technological voyage with us today!



VISION & MISSION

OUR VISION

To be the leading platform where businesses scale smarter—through secure, agile, and intelligent digital infrastructure.



OUR MISSION

Our mission is to deliver smart, scalable IT solutions that help enterprises grow faster—through innovation, reliability, and seamless integration of cloud, data center, and automation systems.

CORE VALUES



INTEGRITY

Maintaining honesty and transparency in all dealings with clients, partners, and employees



INNOVATION

Continuously seeking and implementing creative and cutting-edge solutions to address client needs.



CLIENT-CENTRIC APPROACH

Prioritizing the needs and goals of clients, ensuring their satisfaction and success.



COLLABORATION

Fostering a collaborative environment, both internally and with clients, to achieve the best outcomes.



EXCELLENCE

Fostering a collaborative environment, both internally and with clients, to achieve the best outcomes.



AGILITY

Being adaptable and responsive to changing technologies, markets, and client requirements.



SUSTAINABILITY

Promoting sustainable practices and solutions that consider long-term impacts on the environment and society.

OUR SERVICES

- 1 Data Center Consulting Service
- 2 Data Center Contracting
- 3 Data Center as a Service
- 4 IOT & AI Solutions
- 5 Product Line



1. CONSULTANCY SERVICES

FEASIBILITY STUDY

Evaluate potential sites to ensure they meet operational, environmental and regulatory standards. It covers power, cooling, connectivity and geographic risks, providing insights to support site selection and alignment with business needs.

AUDITING SERVICES

Provide comprehensive assessments of data center covering from Design, Facilities, Operations based on leading international standards like TIA-942, DCOS, etc.

DC INVESTMENT PORTFOLIO

Provide expert guidance in developing and managing a diverse portfolio of data center investments including analyze market trends, assess potential opportunities, conceptual design, technology explanation and risk management.

LEGAL ADVISORY

Our specialized guidance on regulatory compliance, contractual agreements, and data protection specific to data center operations. We help clients navigate complex legal landscapes, ensuring adherence to industry standards, mitigating risks, and securing assets for smooth and compliant data center management.

DCOS® AUDIT CONSULTANCY

As a leading provider of data center solutions, USDC Technology specializes in TIA-942 and DCOS audit consultancy and certification services. We are dedicated to empowering and enhancing your data center, ensuring excellence from design through to operation and beyond.

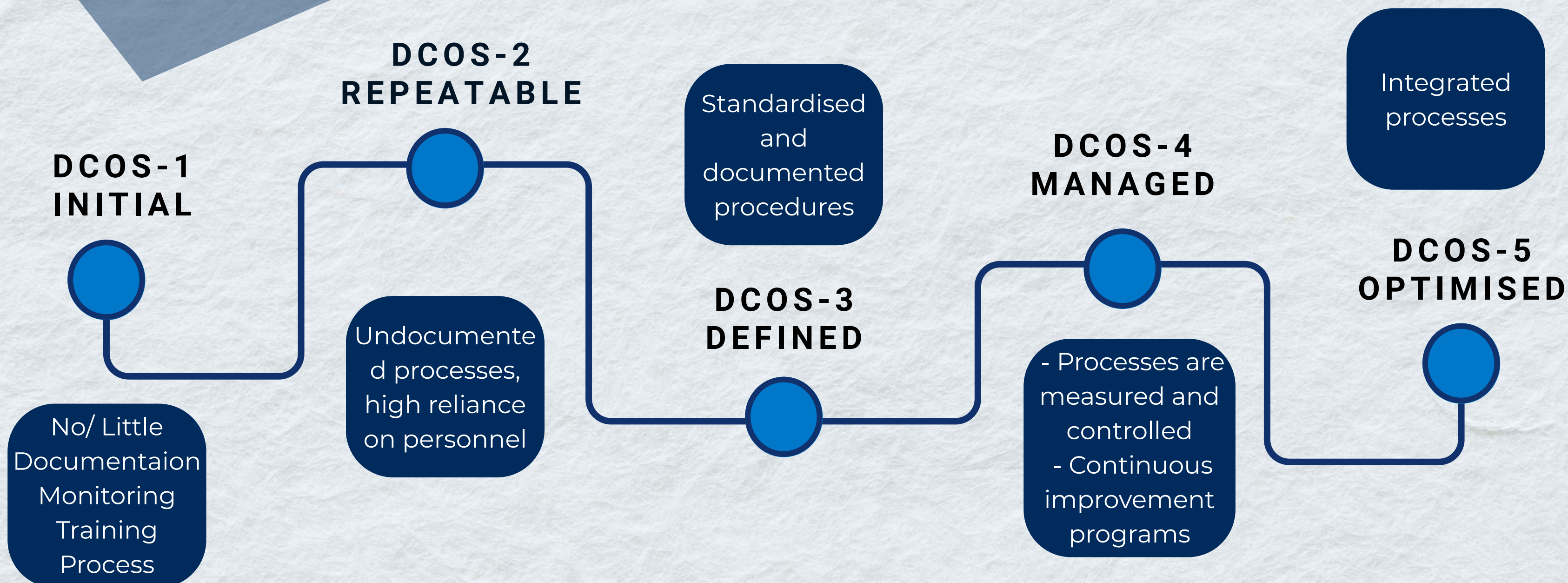



TIA 942 CERTIFICATION



DESIGN

The design documents under scope have been reviewed for conformity to the design criteria of the ANSI/TIA-942 standard for the respective rating level.



FACILITIES

The facility and related design documents have been physically onsite inspected for conformity to the ANSI/TIA-942 standard for the respective rating level.



READY

A modular data center, has been designed in accordance to the ANSI/TIA-942 standard for the respective rating level.

2. END TO END PROCESS

CONTRACTING SERVICE

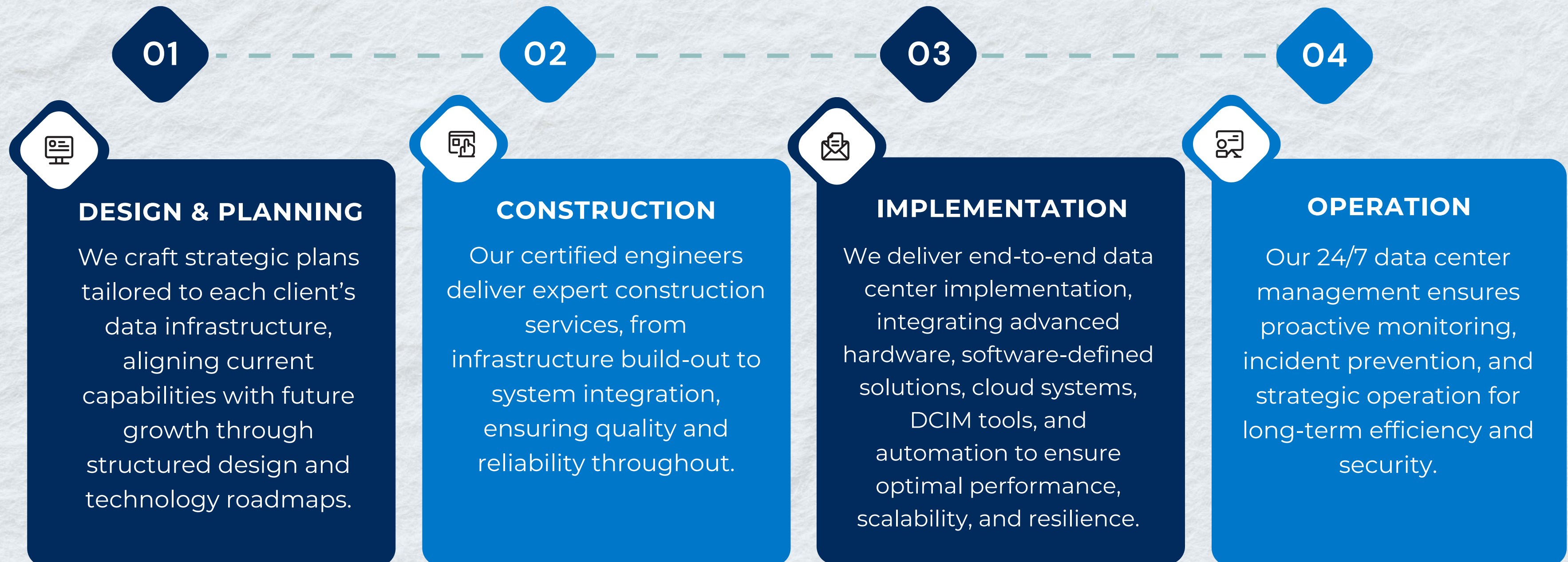

3. DATA CENTER AS A SERVICE (DCAAS)

01

Collocation

04

Virtual Data Center

02

Private Data Center

05

Data Center Neutral Connectivity

03

Bare Metal

06

Edge Data Center



Data Center as a Service



Collocation

Carrier-neutral colocation with 24/7 support, intelligent monitoring, and full deployment control for power, cooling, and connectivity



Private Data Center

Custom-built private suites with high-density power (20kW+/rack), concurrent maintainability, and advanced physical security.



Bare Metal

Dedicated physical servers for maximum performance and customization, ideal for compute-intensive or latency-sensitive workloads.

Data Center as a Service



Virtual Data Center

Enterprise-grade virtual infrastructure on shared physical servers with logical isolation, scalability, and security.



Data Center Neutral Connectivity

Cross-connect services to major ISPs and carriers via hardwired, low-latency infrastructure across our interconnection hubs.



Edge Data Center

Modular and micro edge solutions that bring compute, storage, and networking closer to users for real-time responsiveness.

4. IoT & AI Solutions

1

IoT (Internet of Things)

A network of interconnected hardware devices utilizing physical cabling, 4G, or 5G infrastructure to collect and transmit data over the internet.

2

AI (Artificial Intelligence)

An intelligent data analytics platform that processes information to automatically generate alerts, recommendations, or decisions based on customer-specific requirements.

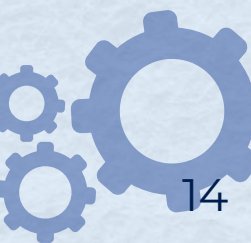

IoT & AI Solutions

Real-World Applications

✓ Smart Buildings

Energy monitoring, security surveillance, and environmental control.

✓ Smart Schools

Access management, attendance tracking, and interactive classrooms.





✓ Factories / Industrial Parks

Infrastructure and equipment management, production optimization.

✓ Hospitals

Patient monitoring and electronic medical record (EMR) management.



✓ Digital Transformation in Public Security

Surveillance, traffic monitoring, and image data analysis.





5. PRODUCT LINE

All-in-one Custom Data Center Solutions



PRODUCT LINE

Mini Edge Data Center Solutions



ENERGY EFFICIENCY

- Efficient inverter precision air conditioners offer energy-saving solutions.
- IP55-rated built-in cold/hot aisle containment enhances thermal management.
- Intelligent monitoring optimizes energy management, significantly reducing PUE.



SECURED PROTECTION

- IP55-rated IT environment with dust resistance, noise reduction, and anti-condensation design for quiet, secure, and stable operation.
- Smart 3-in-1 (PIN/Finger/Rfid) door access system prevents unauthorized entry.
- Real-time equipment monitoring and alarms ensure prompt response.



Smart Monitoring

- Full sensor communication with a real-time management center minimizes downtime.
- Supports multiple protocols and remote access for centralized management and continuous monitoring, boosting efficiency and flexibility.
- Upgraded software interface provides better operational insights.



HIGH FLEXIBILITY

- LEGO-style modular design enables easy customization and expansion.
- Factory prefab and plug-and-play setup simplifies deployment and relocation, saving time and effort.
- Compatible local management system integrates seamlessly into your existing BMS for remote centralized management and monitoring.

PRODUCT LINE

Mini Edge Data Center Solutions

| PRODUCT SPECIFICATION | STANDARD RACK (42U) | CUSTOMIZED RACK (42U) |
|------------------------|---|------------------------|
| Space for IT-U | 26U | 26U / 27U / 29U / 35U |
| Power for IT-KW | 3 | 3.0 ~ 7.0 |
| Width*Depth*Height | 600*1100*2000 | 900*1200*2000 |
| IP level | IP55 | IP55 |
| Input Power | 220-240V/1P/50Hz | 220-240V/1P/50Hz |
| POWER SECTION | | |
| UPS-kVA | 6 | 6.0 ~ 10.0 |
| UPS Type | Rack | Rack |
| Standard Battery | 12V/9AH (16pcs) | 12V/9AH (16pcs) |
| Surge Protection | Yes | Yes |
| Power Panel | Yes | Yes |
| PDU | 16 Slots | 16 Slots (Basic/Smart) |
| COOLING SECTION | Packaged DX / Split DX / Chilled Water | |
| Capacity-KW | 3.5 | 3.5 ~ 7.6 |
| Emergency Ventilation | Yes | Yes |

PRODUCT LINE

Mini Edge Data Center Solutions

| PRODUCT SPECIFICATION | STANDARD RACK (42U) | CUSTOMIZED RACK (42U) |
|-----------------------|---|-----------------------|
| DCIM SECTION | | |
| Local Display | Touch Screen | Touch Screen |
| Remote Access | Web Access | Web Access |
| Reporting Protocol | Modbus-TCP | Modbus-TCP |
| Management | UPS, Cooling, Temp. & Hum. Sensor, Smoke Sensor, Water Sensor | |
| SECURITY SECTION | RFID/Finger/Pin | |
| EXTEND OPTIONS | FM200 Rack Module / Vesda / Video Surveillance | |

Beginning

Expansion

Future



Scalable Infrastructure
Invest in IT as your
business grows!

STRATEGIC PARTNERS

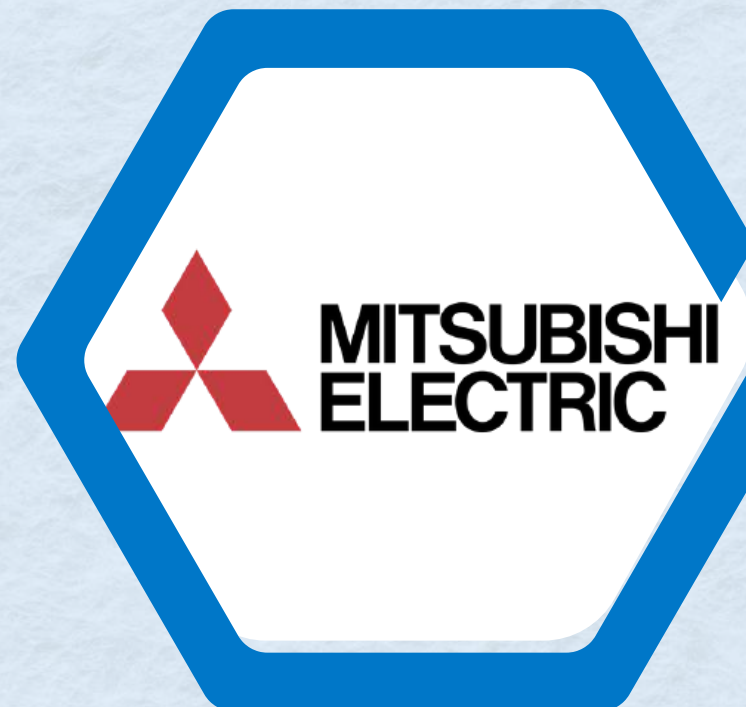

OUR CUSTOMERS



OUR KEY PROJECTS



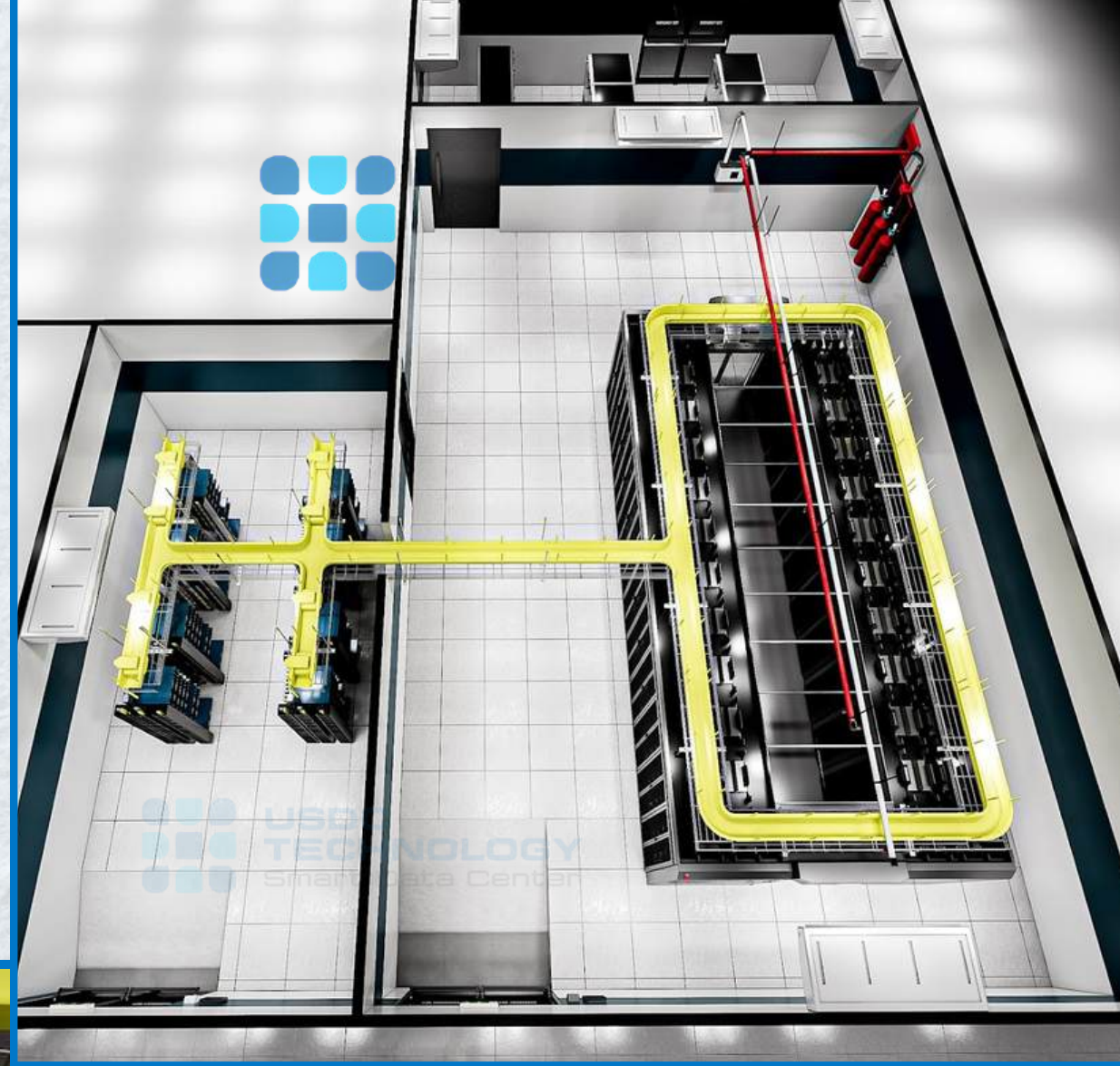

CONTAINER

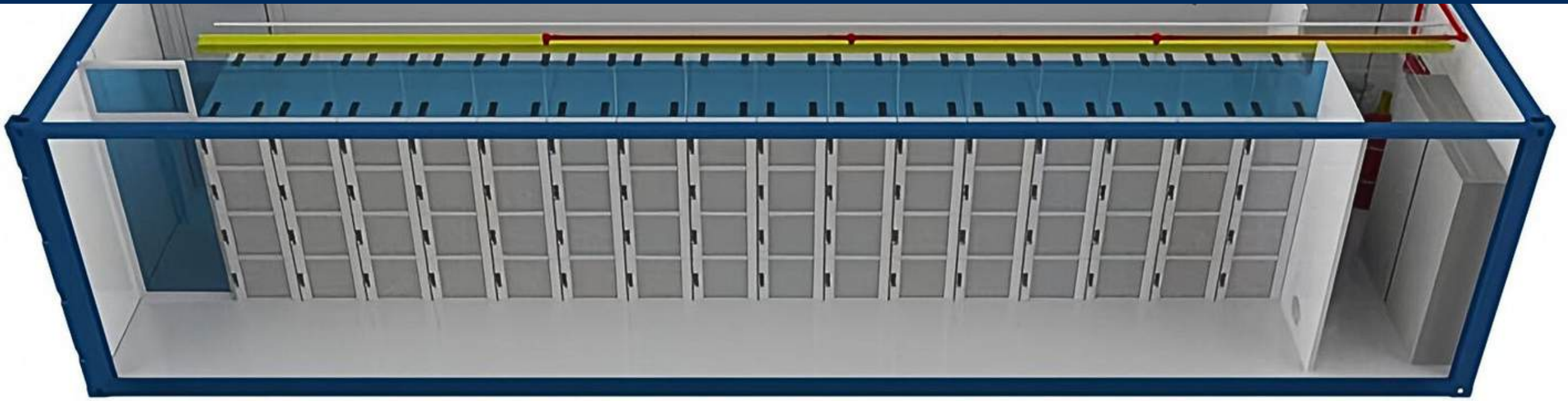

DC BUILDING



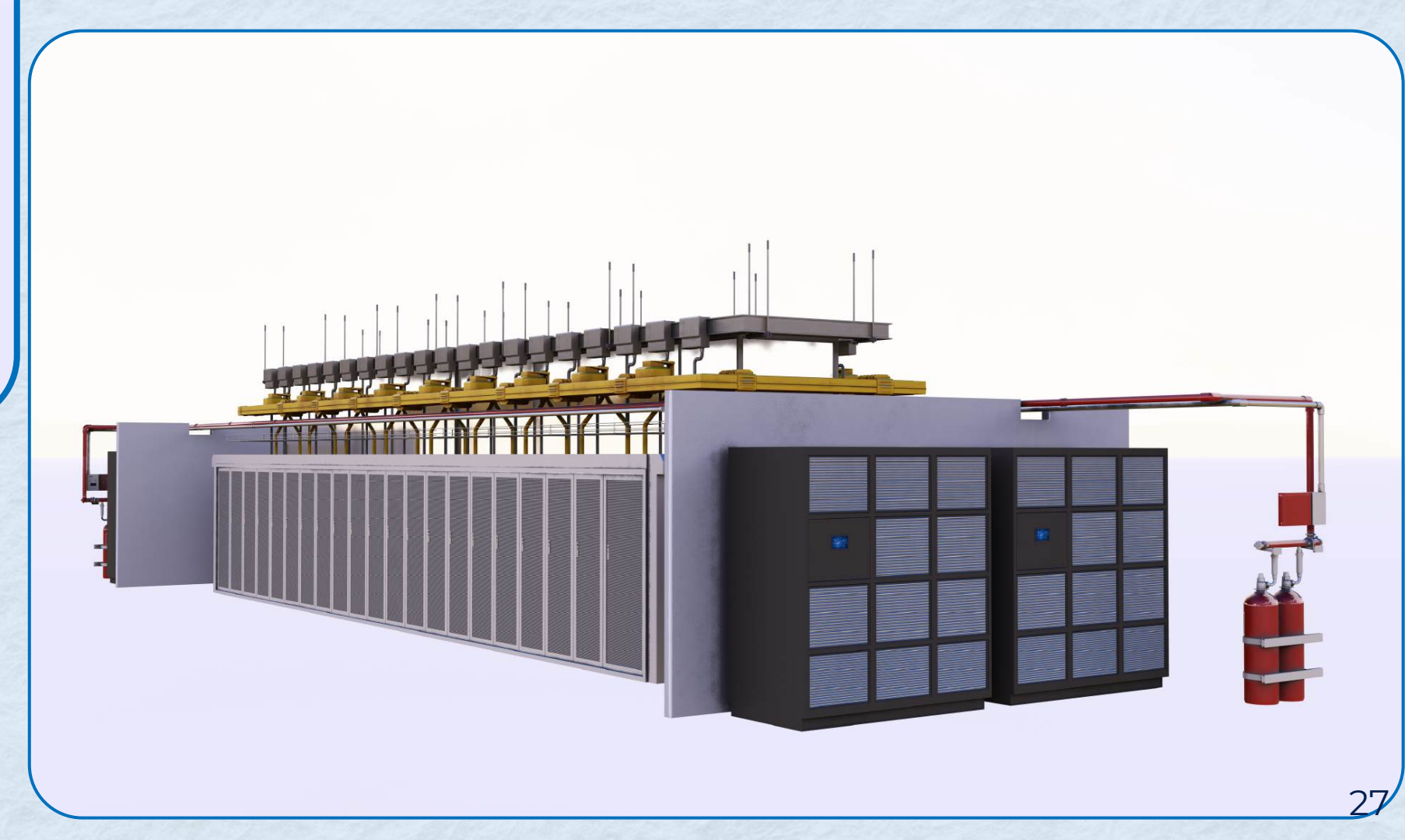
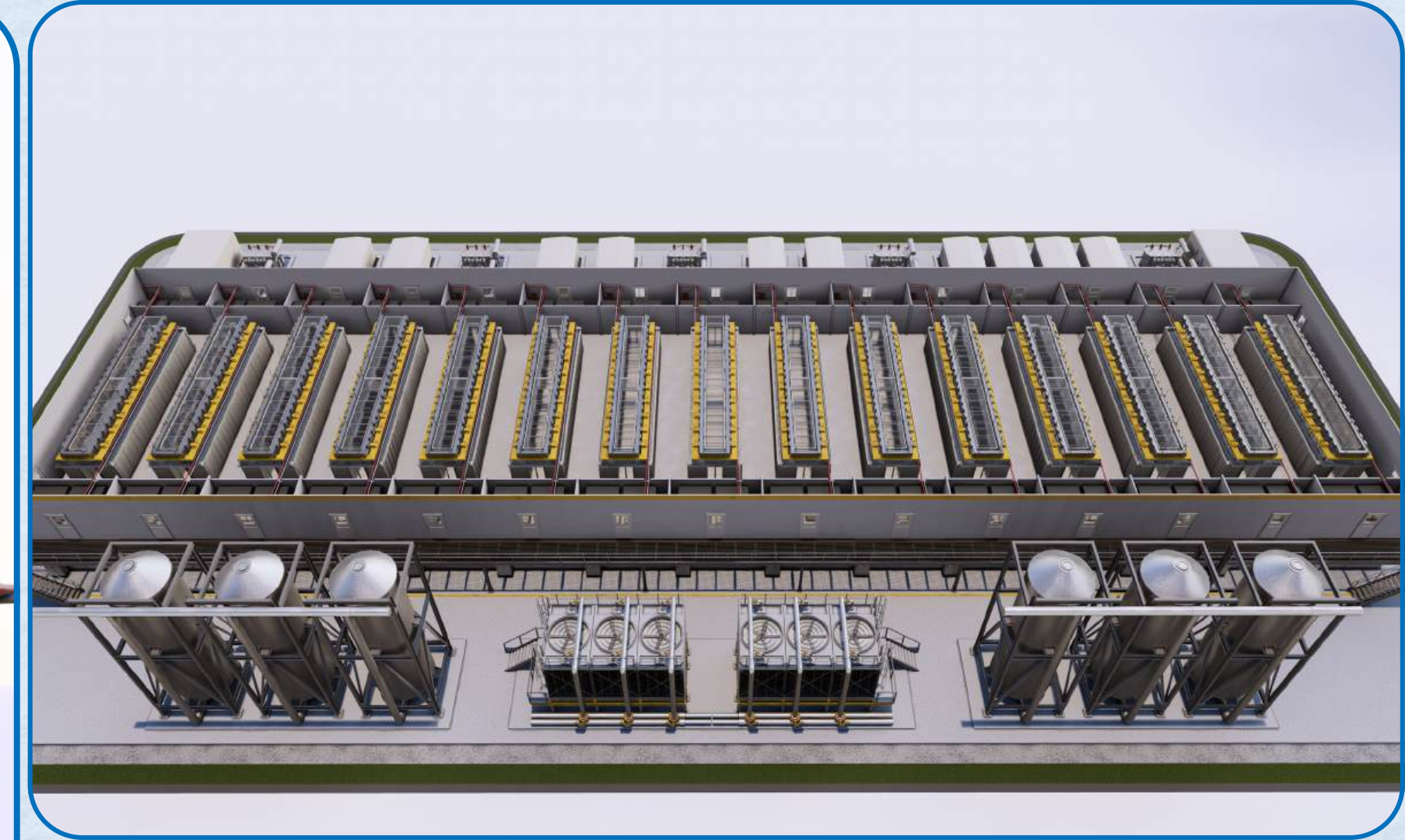
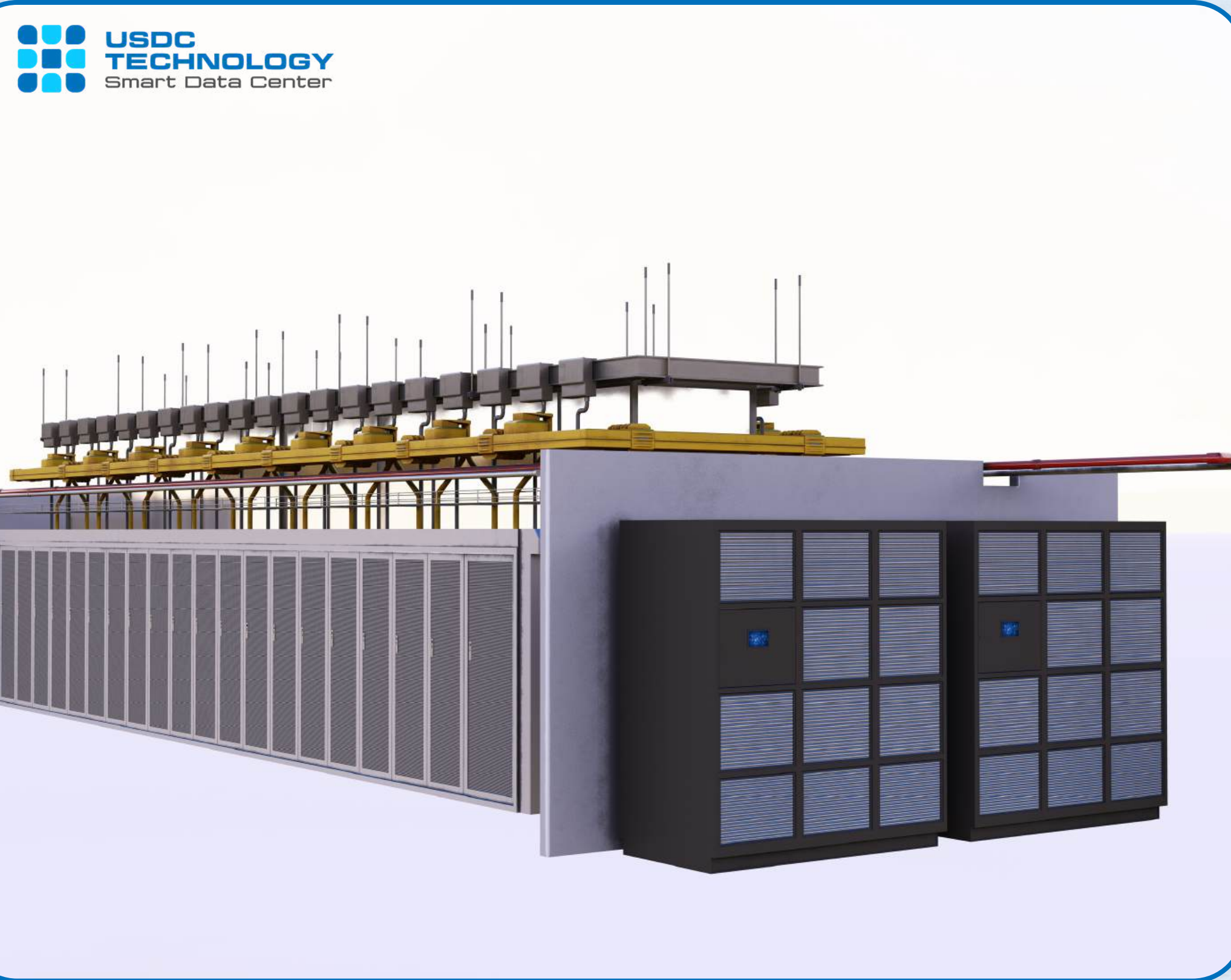

DC HALL

CONTACT US

UNIVERSAL SMART DATA CENTER TECHNOLOGY JSC.

Let's start a conversation about your next DC project.



EMAIL

info@usdc.vn

PHONE

(+84) 28 7308 0708

WEBSITE

<https://usdc.vn/>





THANK YOU